

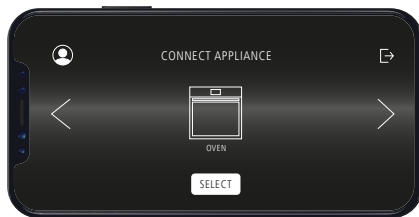

NAME OF THE APPLICATION: CapleHome

DEVELOPER NAME: Maurice Lay Distributors Limited

To satisfy the user's personal privacy rights, we provide the "delete account" function in the App. Users can find the instructions on how to delete their personal account through the following instructions via the CapleHome App:



PRESS 

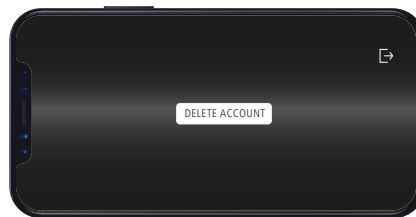

PRESS **DELETE ACCOUNT** BUTTON.

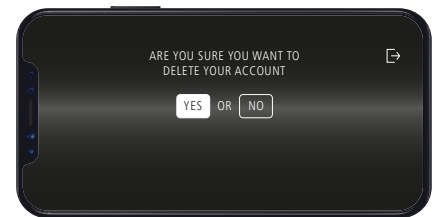

SELECT YES TO DELETE THE ACCOUNT OR NO TO RETURN TO MAIN MENU.

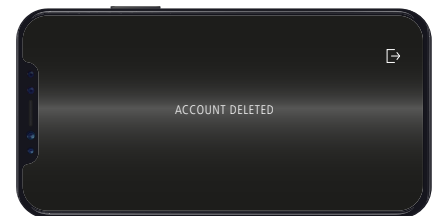

IF YES IS SELECTED AN ACCOUNT DELETED MESSAGE WILL APPEAR.

When a user account is deleted, the following information is permanently deleted:

- > **REGISTERED ACCOUNT DATA:** including **EMAIL ADDRESS, PHONE NUMBER, USER NAME, AND LOGIN CREDENTIALS**, nickname, country code, language preference or time zone information into account.
 - > Feedback: including **EMAIL ADDRESS, MOBILE PHONE NUMBER AND FEEDBACK CONTENT.**
 - > **MOBILE DEVICE INFORMATION*:** including mobile device model number, IP address, wireless connection information, the type and version of the operating system, application version number, push notification identifier, log files, and mobile network information, software version number, the operating environment or to provide services, as well as information about the installed mobile applications and other software you use.
 - > **USAGE DATA:** usage data relating to visits, clicks, downloads, messages sent/received, and other usage of our websites and Services.
 - > **BASIC INFORMATION OF SMART DEVICES:** including device name, device ID, online status, activation time, firmware version, and upgrade information.
 - > **INFORMATION COLLECTED DURING THE PROCESS OF CONNECTING TO A SMART DEVICE:** Based on the type of Smart Device you need to connect, whether the Smart Device is connected via Wi-Fi, after establishing a local connection, we will collect the Mac address of the smart device.
- *SOME OF THE MOBILE DEVICE LOG INFORMATION WILL BE STORED FOR A MAXIMUM OF 7 DAYS AFTER ACCOUNT DELETION.**

When a user account is deleted, we will retain the following information. To ensure that it would not be associated with the user's identity, we will perform automatic deletion on a regular basis according to the data retention mechanism, specifically including the following categories:

- > For the content in user feedback, if there are pictures or videos submitted by the user, and the problem log is submitted, we keep it for further analysis of the problem and find the best solution. When the user applies for personal information (account) deletion, we will follow the 3-year retention period for retention;
- > **LOG INFORMATION:** including IP address, language preference setting, operating system version, date or time of access, so that we can facilitate and accurately identify problems and help users solve them in timely manner, log information will be removed after 7 days.